

1 Dimension :

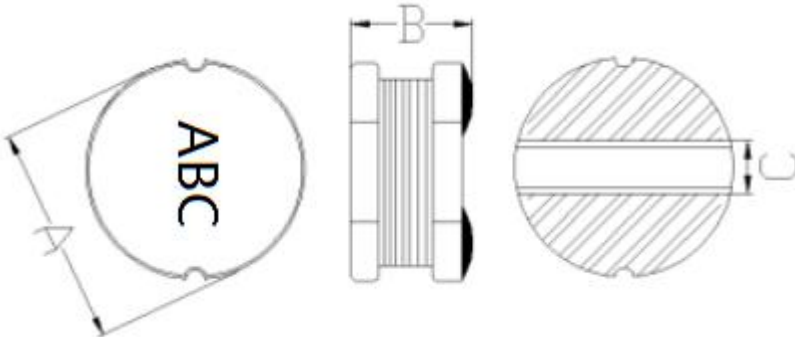

Unit: mm

A	5.8MAX
B	4.8MAX
C	2.3Typ

2 Product Spec. Model

KSE - SD 0604 - 100 M L

 a b f g h

KSE brand

a: Series name

b: Product dimensions code

f: Inductance Value

(1R0:1.0uH; 100: 10uH; 101:100uH)

g: Inductance Tolerance (K:10%; Y:15%; M:20%; N:30%)

h: Package (L: Tape & Reel, B: Bulk)

▶ Lettering direction

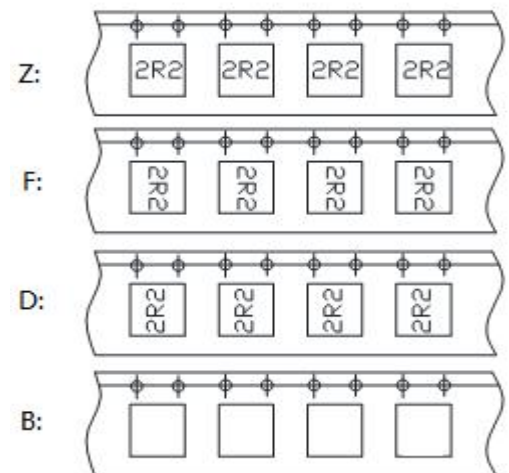

F- direction (typ.)

3 Structure



4 MATERIAL LIST

NO.	PARTS	MATERIAL SPECIFICATIONS	UL FILE NO.	TEMP. CLASS
1	CORE	DR5.6×4.55 B=2.4 F=2.1 OR EQUIVALENT	NA	NA
2	WIRE	G1 P180 OR EQUIVALENT	E258243	180℃
3	SOLDER	Sn99.3-Cu0.7 OR EQUIVALENT	NA	NA

*NA:NOT APPLICABLE.

5 Electrical Characteristics List

Part NO.	Inductance (uH)	Test Freq. (KHz/v)	DCR Max (mΩ)	Isat (A)	WIRE (φ/mm)	TS (Ref)
KSE-SD0604-1R2ML	1.2	100/0.25	19.0	6.00	0.37	6.5
KSE-SD0604-2R2ML	2.2	100/0.25	30.0	5.00	0.35	8.5
KSE-SD0604-3R3ML	3.3	100/0.25	35.1	4.20	0.35	10.5
KSE-SD0604-4R7ML	4.7	100/0.25	49.4	3.20	0.32	13.5
KSE-SD0604-100ML	10	100/0.25	84.5	2.30	0.30	19.5
KSE-SD0604-120KL	12	100/0.25	88.4	2.20	0.29	20.5
KSE-SD0604-150KL	15	100/0.25	110	2.00	0.28	23.5
KSE-SD0604-220KL	22	100/0.25	169	1.60	0.25	29.5
KSE-SD0604-270KL	27	100/0.25	215	1.40	0.23	32.5
KSE-SD0604-330KL	33	100/0.25	266.0	1.30	0.22	35.5
KSE-SD0604-470KL	47	100/0.25	351.0	1.10	0.21	42.5
KSE-SD0604-680KL	68	100/0.25	494.0	0.95	0.19	50.5
KSE-SD0604-101KL	100	100/0.25	741.0	0.75	0.17	61.5
KSE-SD0604-121KL	120	100/0.25	820	0.70	0.17	66.5
KSE-SD0604-151KL	150	100/0.25	1000	0.62	0.16	74.5
KSE-SD0604-221KL	220	100/0.25	1610	0.50	0.14	90.5
KSE-SD0604-331KL	330	100/0.25	2250	0.36	0.13	111.5
KSE-SD0604-471KL	470	100/0.25	3640	0.35	0.11	131.5

Tolerance: N:±30%、M:±20%、K:±10%.

Operating temperature range: -40℃ to +105℃ (Including Self-heating)

Storage temperature rang: -40℃ to +125℃

Isat10%Max (The rated DC current is that which cause at 10%Max inductance reduction from the initial value)