

NOTES:
 Contact resistance: $\leq 20M\Omega$
 Insulation resistance: $\geq 1000M\Omega$
 Rated current: 5A
 Temperature range: $-55^{\circ}C \sim +120^{\circ}C$
 Contact material: Brass
 Contact plated: Ni plated $\geq 30\mu$, Tin plated $\geq 80\mu$,
 Gold plated $\geq 1\mu$.
 Insulator material: PBT
 Withstand voltage: 1000VAC.
 There should be no breakdown and flashover phenomena on the product after one minute.

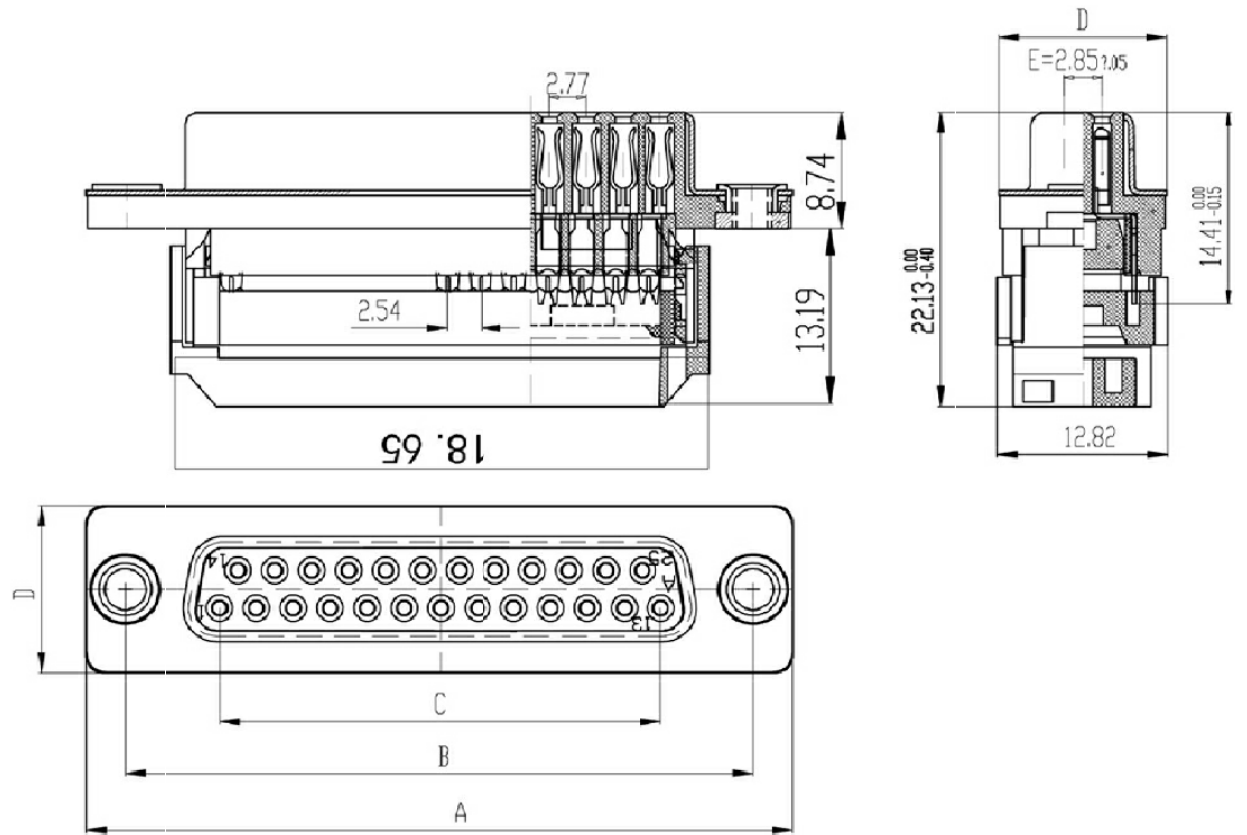

规格	A	B	C	D	E
9	31.00 ^{+0.10} / _{-0.10}	25.00 ^{+0.05} / _{-0.05}	11.08 ^{0.00} / _{-0.10}		
15	39.3 ^{+0.10} / _{-0.10}	33.25 ^{+0.05} / _{-0.05}	19.39 ^{0.00} / _{-0.10}	12.50 ^{+0.10} / _{-0.10}	2.85 ^{+0.05} / _{-0.05}
25	53.10 ^{+0.10} / _{-0.10}	47.06 ^{+0.05} / _{-0.05}	33.24 ^{+0.10} / _{-0.10}		
37	69.5 ^{+0.10} / _{-0.10}	63.5 ^{+0.05} / _{-0.05}	49.86 ^{+0.10} / _{-0.10}		

Total Pitch Tolerances in mm										Nominal dimension range in mm										⊥	≡	-	//				
over 0 to 30	over 30 to 53	over 53 to 70	over 70 to 90	over 90 to 115	over 115 to 150	over 150 to 250	over 250 to 350	over 350 to 500	over 500 to 1000	over 0 to 30	over 30 to 53	over 53 to 70	over 70 to 90	over 90 to 115	over 115 to 150	over 150 to 200	over 200 to 250	over 250 to 320	over 320 to 1000	over 0 to 100	over 100 to 150	over 150 to 150					
±0.18	±0.20	±0.25	±0.3	±0.35	±0.44	±0.60	±0.70	±0.85	±0.20	±0.25	±0.30	±0.35	±0.44	±0.55	±0.70	±0.80	±0.90	0.2	0.3	0.3	0.2	0.3	0.5				

ITEM	NAME OF PART	NO. OF PART	Q'TY	MATERIAL	NOTE
DWG.	SK	DATE	SIZE	A4 UNITS mm	SHEET/OF 1/1
CHK.		DATE	SCALE		
APP.		DATE		DI-XXF	
			DWGNO.		



NOTES:

Contact resistance: $\leq 20m\Omega$
 Insulation resistance: $\geq 1000M\Omega$
 Rated current: 5A
 Temperature range: $-55^{\circ}C \sim +120^{\circ}C$
 Contact material: Brass
 Contact plated: Ni plated $\geq 30\mu$, Tin plated $\geq 80\mu$,
 Gold plated $\geq 1\mu$.
 Insulator material: PBT
 Withstand voltage: 1000VAC.
 There should be no breakdown and flashover phenomena on the product after one minute.

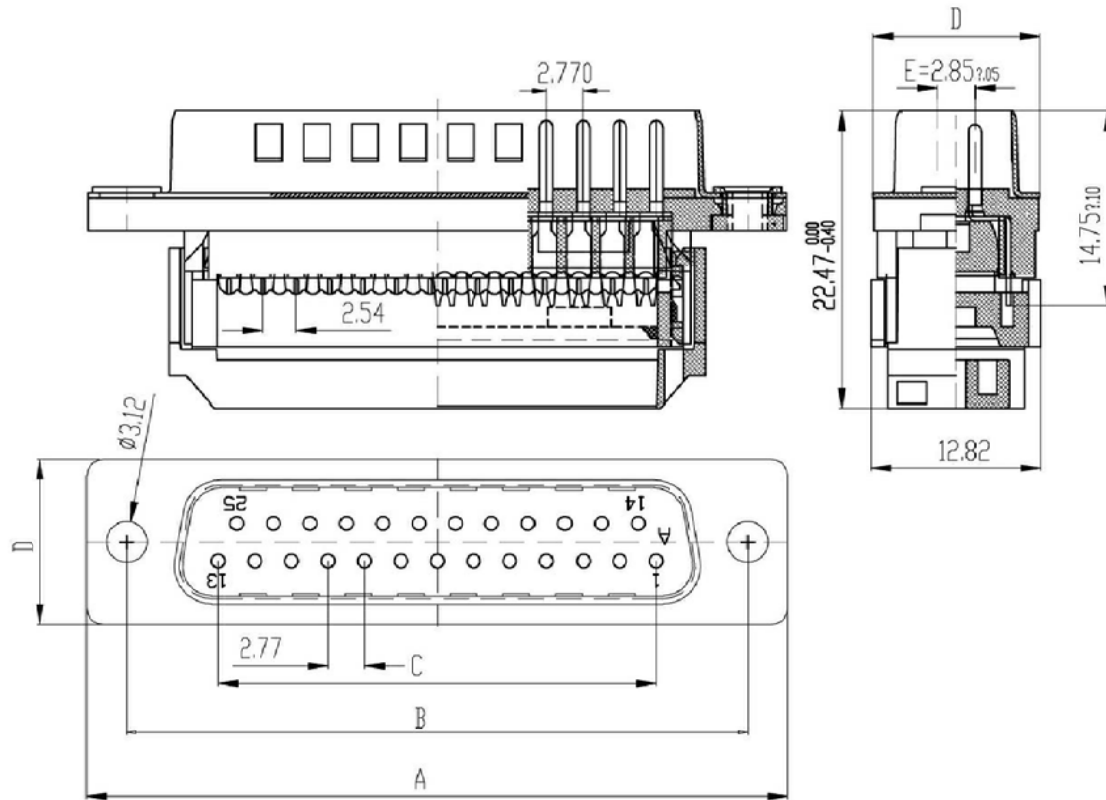

规格	A	B	C	D	E
9	31.00 ^{+0.10} / _{-0.10}	25.00 ^{+0.05} / _{-0.05}	11.08 ^{0.00} / _{-0.10}	12.50 ^{+0.10} / _{-0.10}	2.85 ^{+0.05} / _{-0.05}
15	39.3 ^{+0.10} / _{-0.10}	33.25 ^{+0.05} / _{-0.05}	19.39 ^{0.00} / _{-0.10}		
25	53.10 ^{+0.10} / _{-0.10}	47.06 ^{+0.05} / _{-0.05}	33.24 ^{+0.10} / _{-0.10}		
37	69.5 ^{+0.10} / _{-0.10}	63.5 ^{+0.05} / _{-0.05}	49.86 ^{+0.10} / _{-0.10}		

Total Pitch Tolerances in mm										Nominal dimension range in mm										⊥	≡	-	//								
over 0	over 30	over 53	over 70	over 90	over 115	over 150	over 250	over 350	over 500	over 0	over 30	over 53	over 70	over 90	over 115	over 150	over 200	over 250	over 320	over 0	over 10	all	over 0	over 100	over 150	0.2	0.3	0.3	0.2	0.3	0.5
±0.18	±0.20	±0.25	±0.3	±0.35	±0.44	±0.60	±0.70	±0.85	±1.20	±0.20	±0.25	±0.30	±0.35	±0.44	±0.55	±0.70	±0.80	±0.90	±1.20	0.2	0.3	0.3	0.2	0.3	0.5						

ITEM	NAME OF PART	NO. OF PART	Q'TY	MATERIAL	NOTE
DWG.	DATE		SIZE	A4 UNITS mm	SHEET/OF 1/1
CHK.	DATE		SCALE		
APP.	DATE			DI-XXM	
			DWGNO.		