

承认书

SPECIFICATION FOR APPROVAL

开关电源/Switching Power Supply

CUSTOMER/客户: _____

DESCRIPTION/产品描述: Input:100-240V AC 50/60Hz
Output:3.0-12.0VDC 0.6A

OUR MODEL NO/机种型号: YSV500-600

SAMPLE COLOR/产品颜色: Black (✓) White ()

SAMPLE DATE/产品日期: 2023-08-02

业务/SALES:

核准/APPROVED BY:

设计/DESIGNED BY:

宁海县鹰峤电气有限公司/NinghaiYingjiao Electrical Co.,Ltd.

Tel/电话: 0086-574-27862391、27862392

Add: Cuijia Village Xidian Town Ninghai County Ningbo China 315613

<http://www.yingjiao.com> <http://www.yingjiaodriver.com>

版本/Rev:A0	日期/Date:2023-08-02	描述/Description:新版本/NewRev	制订/Design: Hu
版本/Rev:	日期/Date:	描述/Description:	制订/Design:
版本/Rev:	日期/Date:	描述/Description:	制订/Design:
版本/Rev:	日期/Date:	描述/Description:	制订/Design:

TABLE OF CONTENTS

1、描述 / DESCRIPTION

2、输入特性 / INPUT CHARACTERISTICS

3、输出特性 / OUTPUT CHARACTERISTICS

4、保护功能 / PROTECTION FUNCTION

5、环境要求 / ENVIRONMENTAL REQUIREMET

6、安全及 EMI 要求 / SAFETY AND EMC REQUIREMENT

7、外形尺寸 / OUTLINE DIMENSION

8、铭牌标签 / LABEL

9、包装说明 / PACKING

1、描述/SCOPE:

本规格书适应 YSV500-0600 型号的开关电源。

The purpose of the document is to specify the functional requirements of a 7.2 W switching power supply.

2、输入特性/INPUT CHARACTERISTICS:

2.1 输入电压/Input Voltage:

额定电压/Rated Voltage:100-240Vac

调整范围/Variation Range:90-264Vac

2.2 输入频率/Input Frequency:

额定频率/ Rated Frequency: 50/60Hz.

调整频率/Variation Frequency:47-63Hz

2.3 输入电流/Input Current:

当输入交流电压为额定值的下限电压负载满载时,最大输入交流电流 0.3 A.

0.3 Amps max At any input voltage and rated, DC output rated load.

2.4 AC 漏电流/Ac Leakage Current:

当输入电压 264Vac 时,最大漏电流为 0.7mA(Peak)

0.7mA(Peak) Max.At264Vac input

2.5 浪涌电流/Inrush Current:

当输出为额定负载,环境温度为 25°C,输入 240Vac 冷态起机时的最大浪涌电流小于为 100A.

100Amps Max. Cold start at 240Vac input, with rated load and 25°C ambient.

3、输出特性/OUTPUT CHARACTERISTICS:

3.1 输出功率/Power output

电压 Voltage	最小负载 Min. Load	额定负载 Rated. Load	峰值功率 Peak Load	输出功率 Output power
3.0-12.0Vdc	0.00A	0.6A	0.7-1.2A	7.2W

3.2 负载特性,调整率/Combined Load/Line Regulation

电压 Voltage	最小负载 Min. Load	额定负载 Rated. Load	线性调整 Line Regulation	负载调整 Load Regulation
3.0-5.0Vdc	0.00A	0.6A	±3% (2.91-5.15V)	±10% (2.7-5.5V)
6.0-12.0Vdc	0.00A	0.6A	±3% (5.82-12.36V)	±5% (5.7-12.6V)

3.3 纹波和噪音 Ripple and Noise:

Output Ripple voltage is 200mV peak to peak or less.(100Vac 60Hz / 240Vac 50Hz)

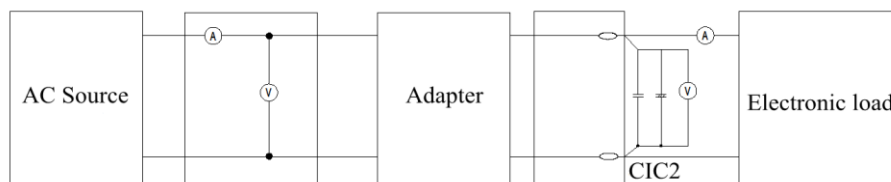

Measured methods:

*The ripple is measured from peak to peak with band width limit of 20MHzC1:0.1uF Ceramics capacitor C2:47uF/50Vluminum capacitor under DC output full load,AC nominal input 25°C ambient temperature).

3.4 启动延迟时间/Turn on delay time:

当输入 100Vac 和输出最大负载时,最大启动时间为 3S.

3Second Max.at 100Vac input and output Max.load.

3.5 上升时间/Rise time:

当输入 100Vac 和输出最大负载时最大时间为 40 mS.

40 mS Max.at 100Vac input and output Max load.

3.6 保持时间/Hold up time:

当输入 100Vac 和输出最大负载时,最小保持时间为 5 mS.

5 mS Min.at 100Vac input and output Max.Load.

3.7 效率/Efficiency:

3V: 65.55% / 4.5V: 68.81% / 5V: 69.64% / 6V: 75.59% / 7.5V: 77.05% / 9V: 78.22%

12V: 80.01% at 115Vac input and output Max.Load

3V: 65.55% / 4.5V: 68.81% / 5V: 69.64% / 6V: 75.59% / 7.5V: 77.05% / 9V: 78.22%

12V: 80.01% at 115Vac input and output Max.Load

3.8 待机功耗 Standby Power:

额定电压 Rated Voltage:100-240Vac 0.1W max

4、保护功能/PROTECTION FUNCTION:

4.1 短路电路保护/Short circuit protection:

该电源供给器在短路解除时能正常工作恢复.

The power supply will be auto recovered when short circuit faults remove.

4.2 过流保护/Over current Protection:

过流故障排除后,电源将恢复正常工作.

The power supply will be auto recovered when over current faults remove.

4.3 过压保护/Output voltage achieve over voltage protection point.will auto protection without output.be capable of auto-recovery function

5、环境要求/ENVIRONMENTAL REQUIREMET:

5.1 工作温度/Operating Temperature:

-20°C-50°C,满载,正常工作.

-20°C to 50°C,Full load, Normal operation.

5.2 储藏温度/Storage Temperature:-40°C to 80°C

带外壳/With package

5.3 工作湿度/Relative Humidity:

25%(0°C)~75%(40°C),72 小时,满载,正常工作.

25%(0°C)~75%(40°C)RH,72Hrs,Full load, Normal operating.

6、安全及 EMI 要求/SAFETY AND EMI REQUIREMENT:

6.1 安规标准/Regulatory Standards

Type	Country	Standard	Type	Country	Standard
UL/FCC	USA	UL62368-1	PSB/CB	SINGAPORE	IEC62368-1
TUV	EUROPE	EN62368-1	PSE	JAPAN	J62368-1
CCC	CHINA	GB4943	KC	KORE	K62368-1
✓ CE	EUROPE	EN62368-1	CSA	CANADIAN	CAS C22.2
RCM	AUSTRALIA	AS/NZ62368-1			

6.2 绝缘阻抗: 输入 500VDC 初级到次级最小阻抗 100MΩ

Insulation Resistance: 500VDC primary to the secondary input impedance of 100MΩ(Min)

6.3 高压/DIELECTRIC WITHSTAND Hi-Pot:

HI-POT-- primary to secondary 3000Vac 5mA 1min

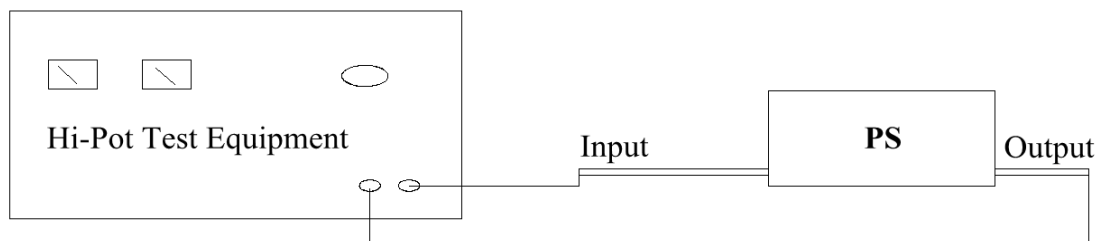

6.4 EMI 标准/EMI STANDARD

测试符合/Meets the Limits of

EN 55032:2015

EN 55035:2017

EN 61000-3-2:2014

EN 61000-3-3:2013

7、外形尺寸/OUTLINE DIMENSION:

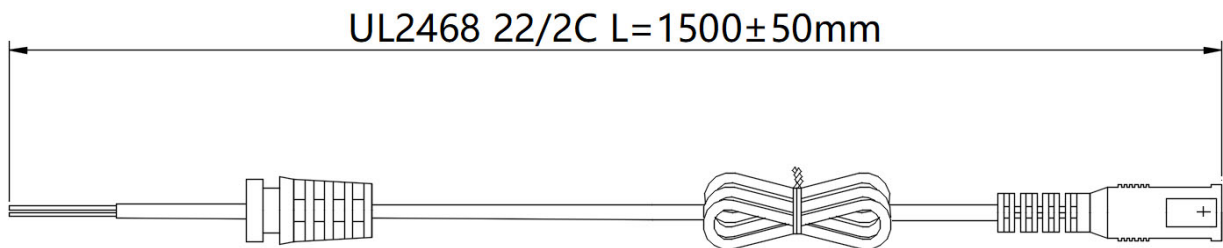
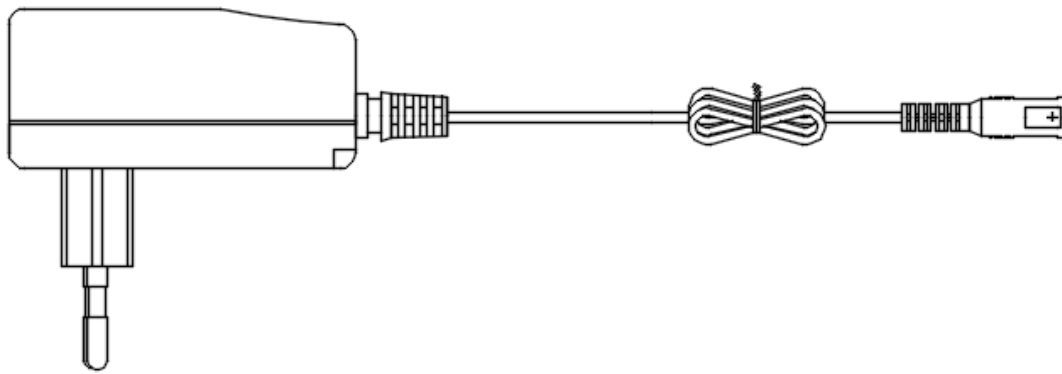
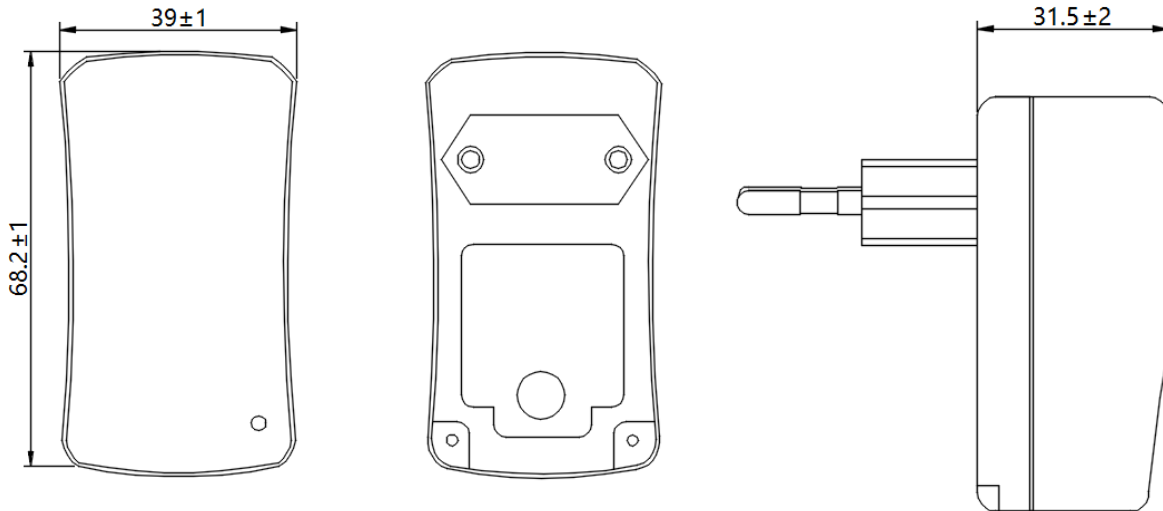

7、外形尺寸/OUTLINE DIMENSION:

3.5*1.35

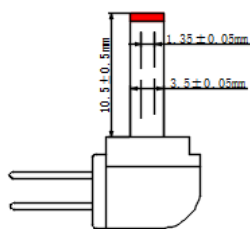

5.5*2.5

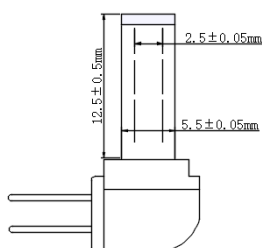

5.5*2.1

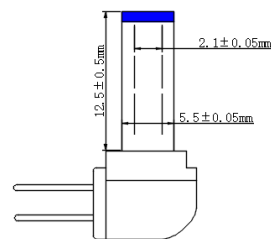

2.35*0.7

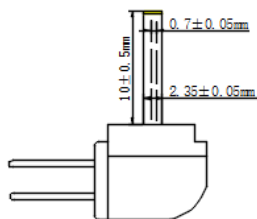

4.0*1.7

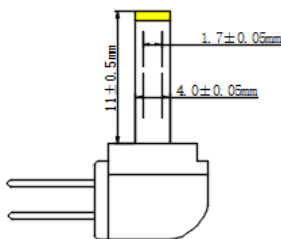

2.5mono

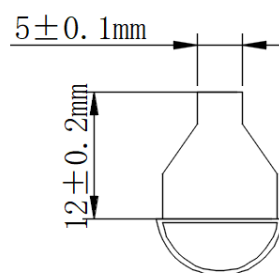
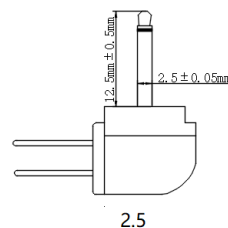

8 铭牌标签/LABEL:

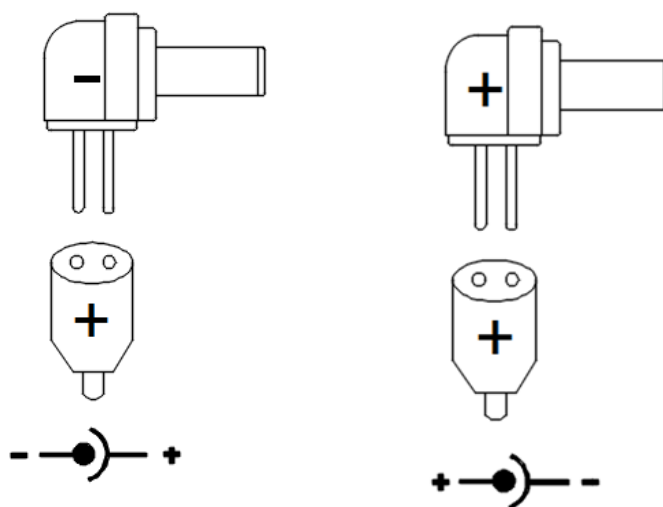
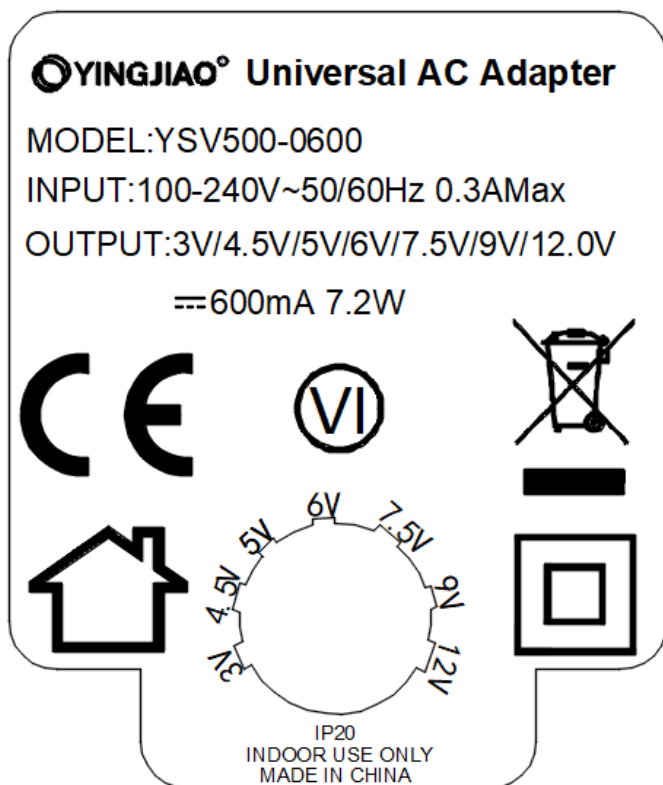

9、包装说明/PACKING STEP:

注：包装仅供参考，以实际大货为准。

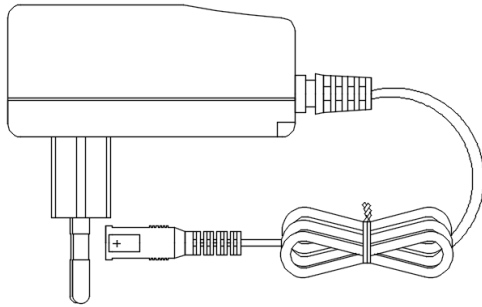

A :Product



装PE袋

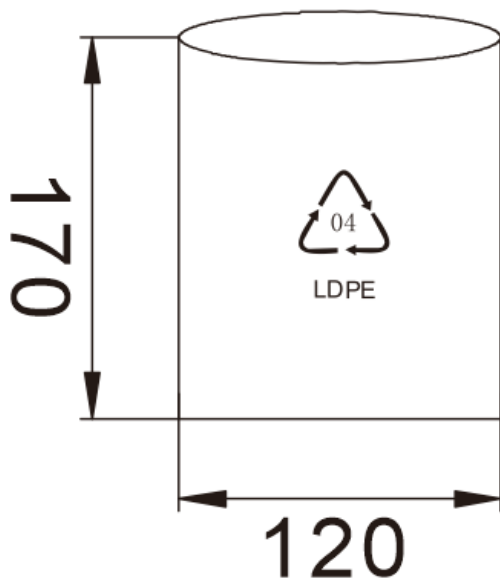

B:PE Bag

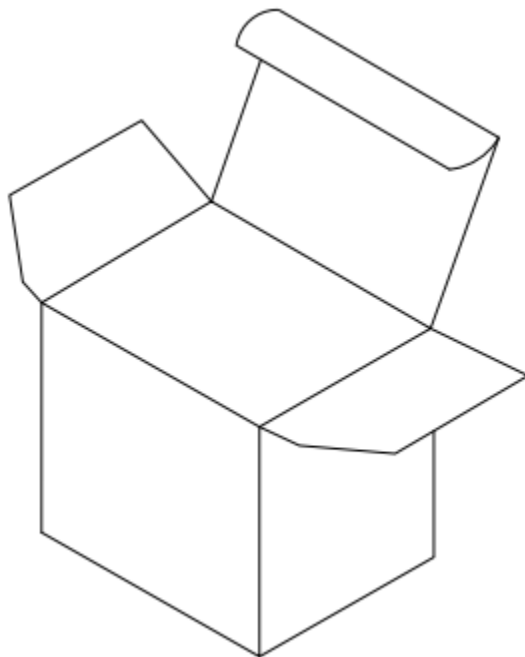
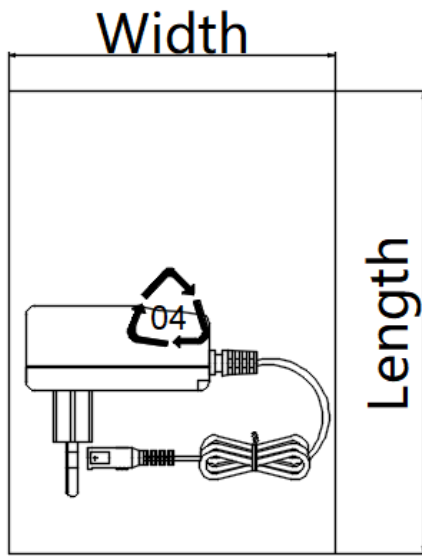

白盒/ White box:

长/ Length:85mm

宽/ Width:52mm

高/ Height:75mm

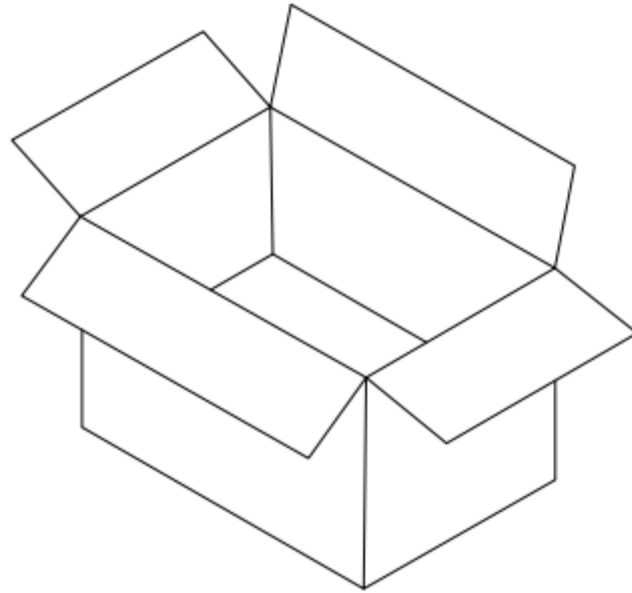

Packing request:

Packaging

Outside box:450L*285W*320H

Quantity:100PCS/CTN

Remarks:

1. Firstly, put the product into PE bag according to the picture "A/B".
2. After finishing the first step, then put the product into White box according to the picture "C".
3. Then put the product into outer carton.
4. When packing finished, then seals the carton and labels the mark.
5. Through the QA inspection, the products can be shipped