



**SPECIFICATIONS**

Rated Current:3.0AMP  
 Contact Resistance:20mΩ Max  
 Withstand Voltage:1000V AC/DC  
 Insulation Resistance:1000MΩ Min  
 Operation Temperature:-40°c to +105°c

Contact Material:Brass  
 Contact Plating:Au Over Ni  
 Insulator Material:Polyester(UL94V-0)  
 Standard: PA6T  
 Max.Processing Temp: 230°C for 30-60 seconds  
 (260°C for 10 seconds)

Recommended P.C.B Layout(Top Side)  
 (PCB BOARD TOLERANCE±0.05)

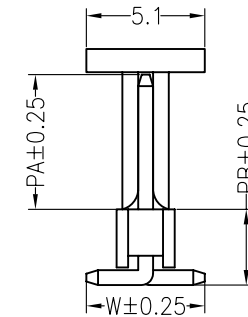
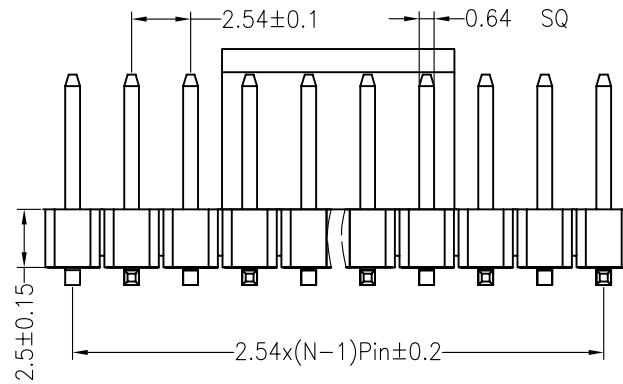
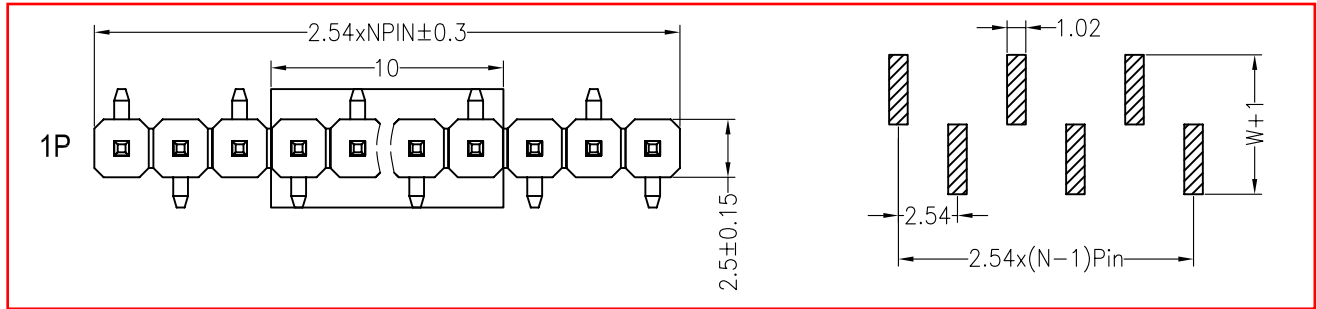

Dimension antitheses list				
ITEM	PA	PB	W	L
Standard	6.00	3.20	5.00	11.00
Alternate	6.00	4.10	4.80	11.80

				OPERATION		DRAW	YiYuSheng	12.03.28	SCALE	FIT	NINGBO KLS ELECTRONIC CO., LTD.		
				X.X	±0.30				UNIT	mm			
				X.XX	±0.20	CHECK	SIZE	A4	PART NO.	L-KLS1-207-1-XX-T1C-R			
				X.XXX	±0.10		SHEET	1/1					
A0	2012.03.28	NEW DRAWING		Angle	±3°	APPROVE	PROJ.	◆	TITLE:	2.54mm Pin Header 2.5mm SMT Reel with cap			
REV	DATE	MODIFICATION DESCRIPTION		DIM	TOL								